

## WIRING DIAGRAM

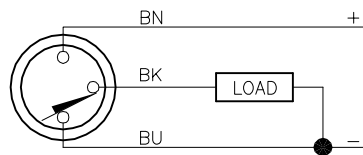

OUTPUT: RP6X

SHORT-CIRCUIT AND OVERLOAD PROTECTED

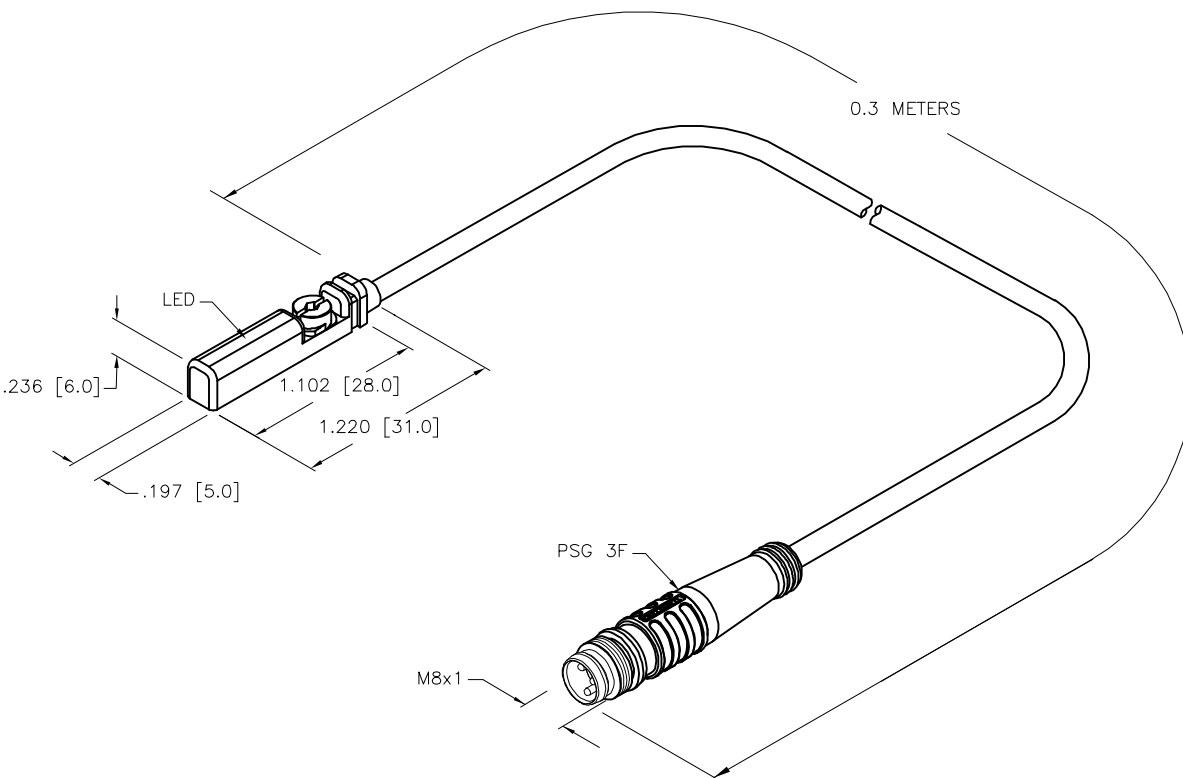

## SPECIFICATIONS

|                               |   |
|-------------------------------|---|
| PASS SPEED                    | ≤ 10 m/s                                |
| HYSTERESIS                    | ≤ 1mm                                   |
| TEMPERATURE DRIFT             | ≤ 0.1mm                                 |
| MIN. ABSOLUTE REPEAT ACCURACY | ≥ ±0.1mm                                |
| OPERATING TEMPERATURE         | -25°C to +70°C (-13°F to +158°F)        |
| RATED OPERATIONAL VOLTAGE     | 10-30 VDC                               |
| MAX. RIPPLE                   | ≤ 10%                                   |
| DC RATED OPERATIONAL CURRENT  | ≤ 150 mA                                |
| NO-LOAD CURRENT               | ≤ 15 mA                                 |
| RESIDUAL CURRENT              | ≤ 0.1 mA                                |
| MAX. SWITCHING FREQUENCY      | ≤ 1.0 kHz                               |
| RATED INSULATION VOLTAGE      | ≤ 0.5 kV                                |
| OUTPUT FUNCTION               | NORMALLY CLOSED, 3-WIRE, PNP            |
| SHORT-CIRCUIT PROTECTION      | YES, CYCLIC                             |
| MAX. VOLTAGE DROP             | ≤ 1.8 V                                 |
| WIRE BREAKAGE PROTECTION      | INCORPORATED                            |
| REVERSE POLARITY PROTECTION   | INCORPORATED                            |
| HOUSING MATERIAL              | PLASTIC, PP                             |
| ACTIVE FACE MATERIAL          | PLASTIC, PP                             |
| CABLE                         | ø3.0, LifYY-11Y, TPU                    |
| VIBRATION                     | 55 Hz, 1 mm AMPLITUDE (IN ALL 3 PLANES) |
| SHOCK                         | 30 g, 11 ms                             |
| DEGREE OF PROTECTION          | IP68                                    |
| SWITCHING STATUS INDICATION   | LED, YELLOW                             |
| INCLUDED IN SCOPE OF SUPPLY   | CABLE CLIP                              |

SOURCE DRAWING - FOR REFERENCE ONLY

|   |   |  |     |  |          |
|---|---|--|-----|--|----------|
| RELATED DOCUMENTS<br>1.<br>2.<br>3.<br>4. | 3RD ANGLE PROJECTION<br>  | THIS DRAWING IS CONFIDENTIAL AND THE PROPERTY OF TURCK INC. USE OF THIS DOCUMENT WITHOUT WRITTEN PERMISSION IS PROHIBITED. |     | <b>TURCK</b><br>3000 CAMPUS DRIVE<br>MINNEAPOLIS, MN 55441<br>1-800-544-7769<br>(763) 553-7300<br>(763) 553-0708 fax<br>www.turck.us |          |
|   |   | DRFT   | RDS | DATE   | 07/11/08 |
|   | ALL DIMENSIONS DISPLAYED ON THIS DRAWING ARE FOR REFERENCE ONLY | APVD   |     | SCALE  | 1=1.0    |
|   |   | UNIT OF MEASUREMENT<br><b>INCH [ MILLIMETER ]</b>  |     | DESCRIPTION<br>BIM-UNT-RP6X-0.3-PSG3F  |          |
| MATERIAL                                  | CONTACT TURCK FOR MORE INFORMATION                              | IDENTIFICATION NO.<br>4685785  |     | REV<br>D   |          |
| FINISH                                    |   | DO NOT SCALE THIS DRAWING  |     | FILE: 4685785 SHEET 1 OF 1   |          |

|     |   |     |          |          |
|-----|---|-----|----------|----------|
| D   | UPDATE SENSOR BODY AND PROTECTION CLASS | RDS | 02/11/21 | 76490    |
| REV | DESCRIPTION                             | BY  | DATE     | ECO. NO. |